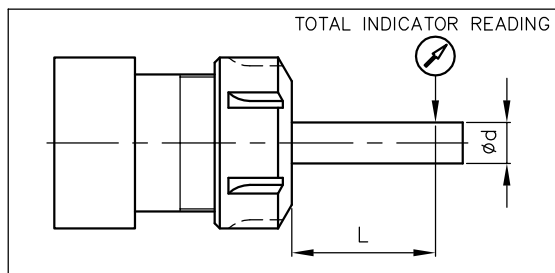
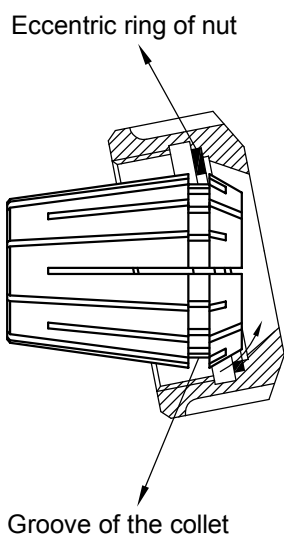

RUNOUT DETAILS:

CLAMPING RANGE ϕd		L (mm)	RUNOUT (TIR)		
ABOVE	UPTO		PRECISION	HIGH PRECISION	I-A
1.0	1.5	6.0	0.015	0.010	0.010
1.5	3.0	10.0	0.015	0.010	0.010
3.0	6.0	16.0	0.015	0.010	0.010
6.0	10.0	25.0	0.015	0.010	0.010
10.0	18.0	40.0	0.020	0.015	0.010
18.0	26.0	50.0	0.020	0.015	0.010
26.0	34.0	60.0	0.020	0.015	0.010

METHOD OF INSERTION & RELEASE OF RD COLLETS

INSERTION: Introduce collet into the clamping nut at an angle as shown in the sketch and turn the nut till it snaps into the groove of the collet.

Insert the tool to be gripped into the collet and screw the nut on to the collet holder with collet securely in the nut.

Important: Never screw the nut on to the collet holder unless collet is properly seated in the nut.

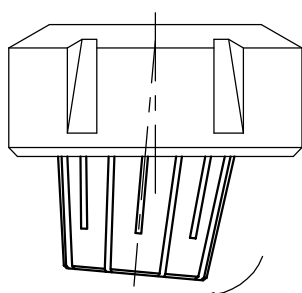

RELEASE: By unscrewing the clamping nut from the collet holder the collet is pulled automatically by means of the eccentric ring in the nut.

Hold the nut in the vertical position and remove nut at an angle.