

RDG COLLETS

Interchangeable with
TG Type Collets

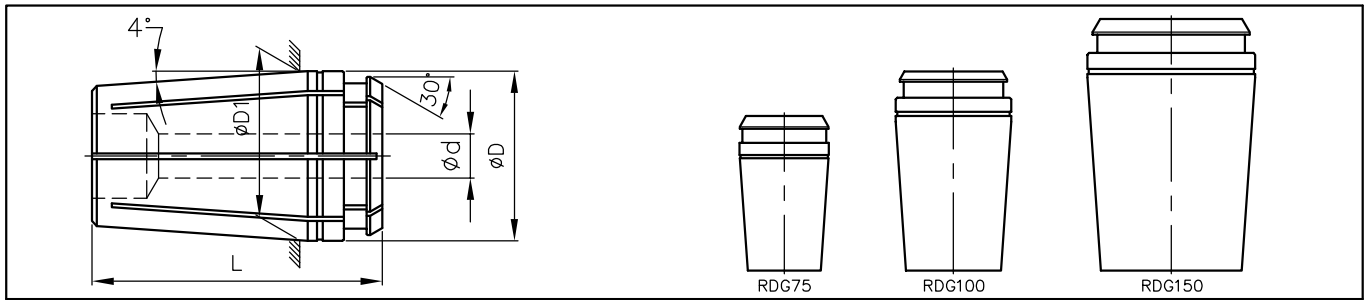

TYPE OF COLLET	ϕD	ϕD_1	L	BORE DETAILS						COLLET		NO OF PCS/SET		
				ϕd Bore Range				IN STEP OF		TYPE	COLLAPSES BY		MM INCH	
				INCH		MM		INCH	MM		INCH	MM	MM	INCH
				FROM	To	FROM	To							
RDG75	27.002	26.695	46.830	3/32	11/32	2.0	9.0	1/64	0.50	C/B *	1/64	0.50	35	43
				23/64	3/4	9.5	20.0							
RDG100	35.026	35.000	60.325	3/32	43/64	2.0	17.0	1/64	0.50	C/B	1/64	0.50	47	59
				11/16	1"	17.5	25.0							
RDG150	50.825	50.698	76.200	1/2	1 13/32	12.5	35.5	1/64	0.50	C/B	1/64	0.50	52	65
				1 27/64	1 1/2	36.0	38.0							

* C/B = Counterbore, T/B = Throughbore

Also available are:

1. Sealed collets for coolant through application (For details refer page no. 12)
2. Any other bore size on request at extra cost

RUNOUT DETAILS:

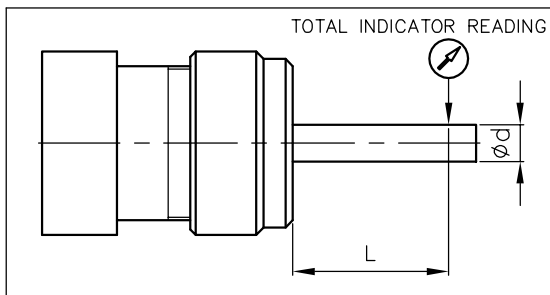

CLAMPING RANGE ϕd (mm)		L (mm)	RUNOUT (TIR) mm		RUNOUT (TIR) Inch	
ABOVE	UPTO		PRECISION	HIGH PRECISION	PRECISION	HIGH PRECISION
1.0	1.5	6.0	0.015	0.010	0.0006"	0.0004"
1.5	3.0	10.0	0.015	0.010	0.0006"	0.0004"
3.0	6.0	16.0	0.015	0.010	0.0006"	0.0004"
6.0	10.0	25.0	0.015	0.010	0.0006"	0.0004"
10.0	18.0	40.0	0.020	0.015	0.0008"	0.0006"
18.0	26.0	50.0	0.020	0.015	0.0008"	0.0006"
26.0	40.0	60.0	0.030	0.020	0.0008"	0.0006"

Ordering Instruction:

RDG100-1/4"-HP

Collet Type	Bore size	Runout (TIR)
-------------	-----------	--------------